

DETAIL OF 90° BEND FOR DUCT Ø 2190 - D20

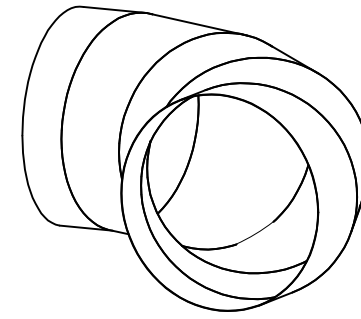

ISOMETRIC VIEW

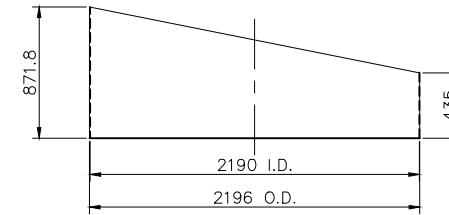

DETAIL OF ITEM No. 2

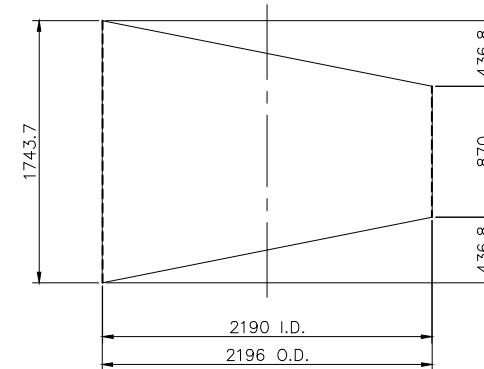

DETAIL OF ITEM No. 3 & 4

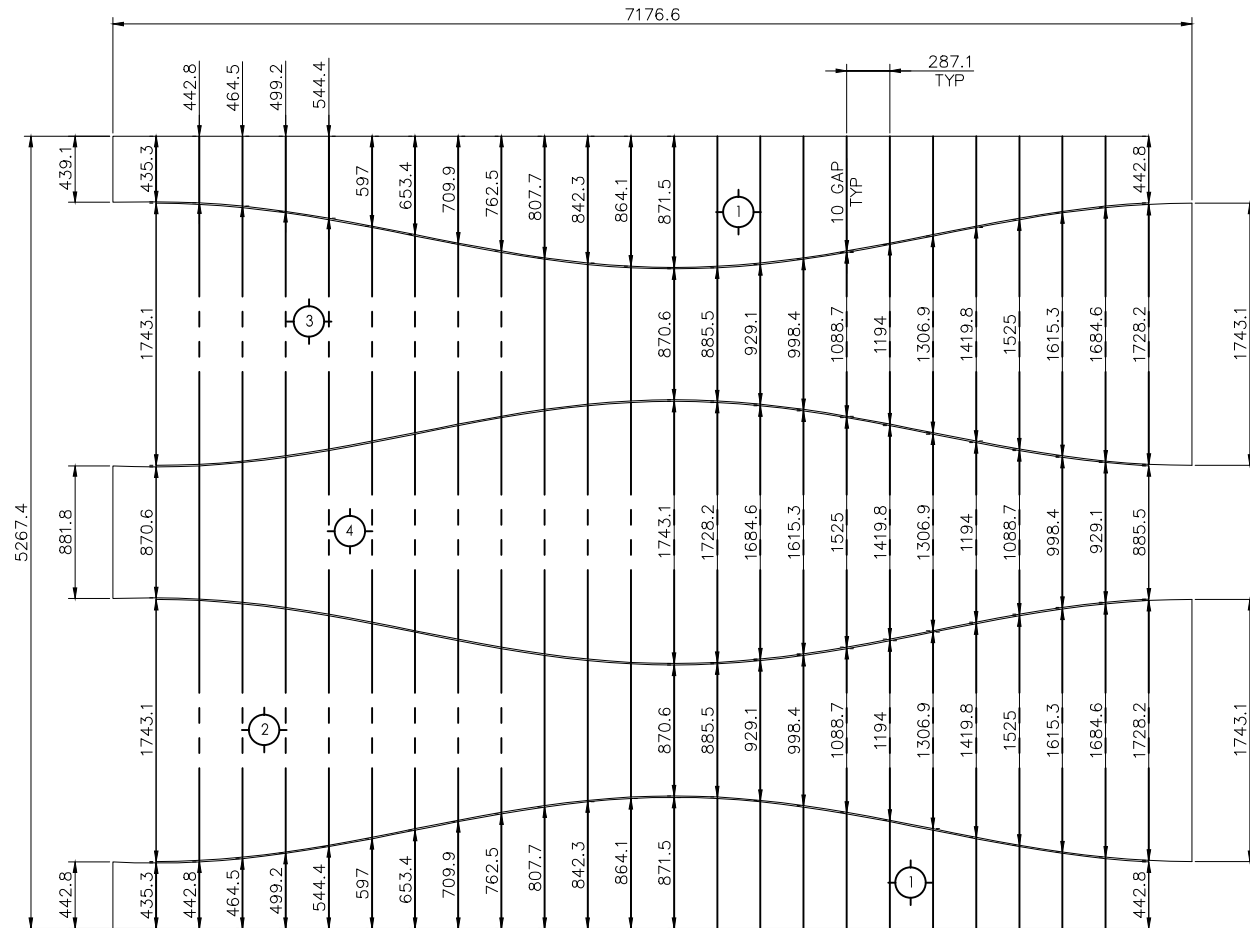

PLATE CUTTING METHOD OF BEND - D20

MATERIAL LIST						
ERECTION Mark	Mark	Size	Grade	Qty.	Length	Weight
	D21	PL 3 THK. x 5268	S235 JR	1	7177	897.00
TOTAL						897.00 KG.

ASSEMBLY MK'D D20
QTY. 2 NOS. REQ'D.

GENERAL NOTES:
 1. ALL DIMENSIONS ARE IN MM, AND ALL LEVELS ARE IN M.
 2. ALL WELDS ARE 3 MM CONTINUOUS FILLET WELD, U.N.O.
 3. ALL SHARP EDGES TO BE REMOVED
 4. S.L - SHIP LOOSE.

01	30-05-12	ISSUED FOR FABRICATION	SCAD	SCAD	JLK
REV.	DATE	DESCRIPTION	DRAWN	CHECKED	APPROVED

ALSTOM Power Environment
Environmental Control Systems

Competence Center, Aluminium

© This document is, unless otherwise agreed in writing, the property of ALSTOM Norway AS, and shall not be reproduced, copied, disclosed to any third party or used for any other purpose other than that for which it is supplied or disclosed.

EMAL PHASE II - GAS TREATMENT CENTRES (GTC) GTC-5332
DETAILS OF 90° BEND FOR Ø2190 DUCT (D20)

Date	30-05-2012	Drawn by	SCAD	Checked by	SCAD	Approved	JLK	Assembly No.	9.9M-1281	Sub No.	sub no	Scale	1:25
REV.	DATE	DESCRIPTION											

Drawing No. EE3-000567 - 9.9M-1364

#	30-05-2012	ISSUED FOR APPROVAL
A	01-05-2012	ISSUED FOR APPROVAL
REV.	DATE	DESCRIPTION

Iscon
Integrated Steel Construction Co. L.L.C.